

S803-S200 series T8 LED Tube
High efficiency | Wattage switchable

200lm/w



Specification

Factory P/N: SL-S803-S200

Version No.: Ver 02

Date: 2020.08.19

| Client approval | Approval | Approval | Confirmation |
|-----------------|----------|----------|--------------|
| | | | |



Applications

- ◆ Indoor illumination at $-20^{\circ} \sim +48^{\circ} \text{ C}$
- ◆ Living area illumination
- ◆ Office area illumination
- ◆ Workshop area illumination
- ◆ Parking lot & hotel area illumination
- ◆ Super market & grocery store illumination

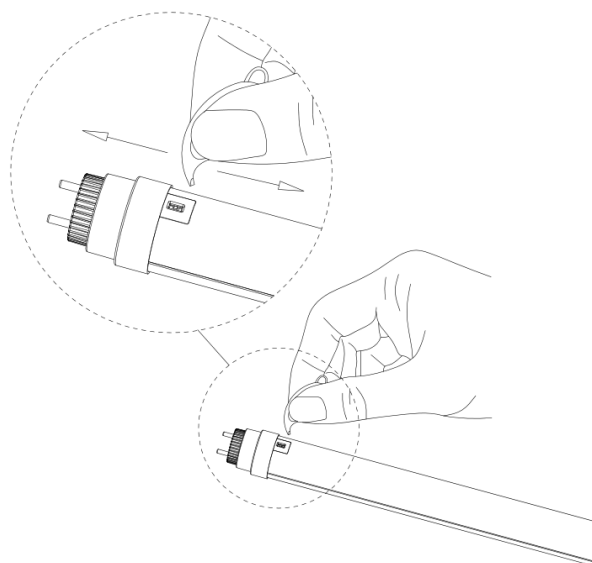

Benefits

- ◆ A6063 aluminum material with excellent heat dissipation, not easy to deform
- ◆ SPD 3KV, effectively prevent the tube from being damaged by on-off switch or instant high voltage
- ◆ Special coating to avoid aluminum exposure
- ◆ Optimal energy conversion, much lower temperature
- ◆ Suitable for lower ambient temperature using

Diagram of code switch for power adjustment

| | | | |
|--------|--|------|--|
| 0.6M | <input type="checkbox"/> 6W <input type="checkbox"/> 9W | 0.9M | <input type="checkbox"/> 9W <input type="checkbox"/> 12W |
| 1.2M | <input type="checkbox"/> 10W <input type="checkbox"/> 15W | 1.2M | <input type="checkbox"/> 12W <input type="checkbox"/> 18W |
| 1.047M | <input type="checkbox"/> 10W <input type="checkbox"/> 15W | 1.5M | <input type="checkbox"/> 16W <input type="checkbox"/> 24W |

Features

- ◆ Safer and more reliable, leading technology
- ◆ Greener and more energy saving, durable structure
- ◆ Higher efficacy to save much more energy
- ◆ Longer Lifespan for very less heat

■ Model number naming rules:

S803 series Tube

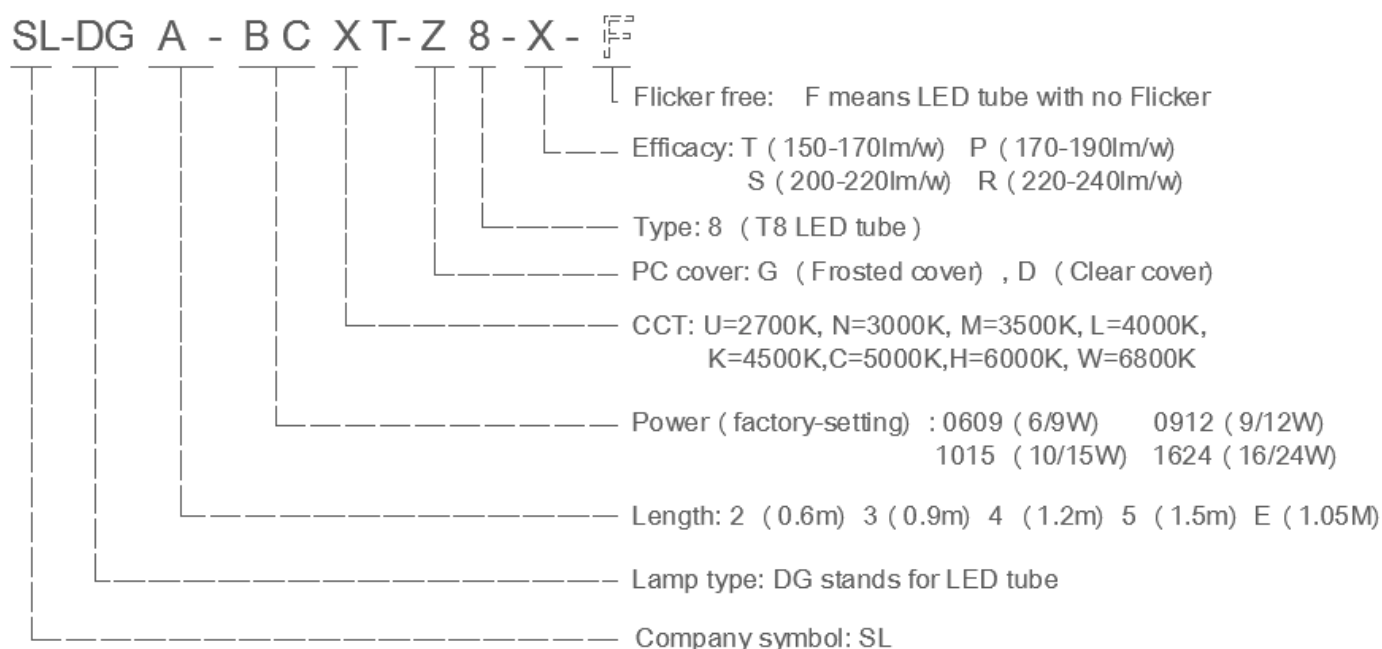

— This series of products are all named according to the above rules —

■ Product Dimension:

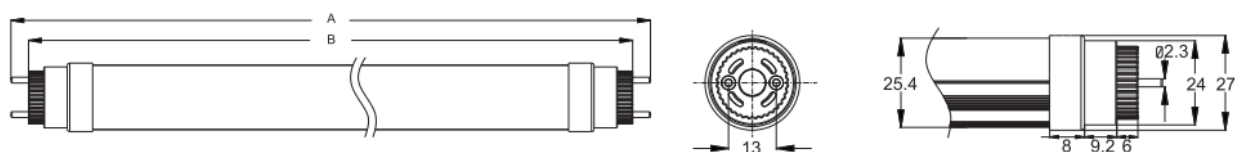

| | 0.6m | 0.9m | 1.047m | 1.2m | 1.5m |
|---|-------|-------|--------|--------|--------|
| A | 603mm | 907mm | 1061mm | 1213mm | 1513mm |
| B | 588mm | 892mm | 1047mm | 1198mm | 1498mm |

■ Basic technical parameters

| Product Length | 0.6m | 0.9m | 1.2m | | 1.5m | |
|------------------------|--|------|------|-----|------|-----|
| Rated Power Switchable | 6W | 9W | 10W | 15W | 16W | 20W |
| Efficacy | 200LM/W | | | | | |
| Rated current | 0.5A | | | | | |
| PF | 0.92 | | | | | |
| CCT | 3000K / 4000K / 5000K / 5700K /600K/ 6500K | | | | | |
| CRI | ≥80 | | | | | |
| Beam angle | Clear cover 120° / Frosted cover 140° | | | | | |
| Start time | < 5S | | | | | |
| Heating time | 0.5 hours (heating 60%) | | | | | |
| Dimmable | No | | | | | |

■ Life Time:

| | |
|--------------------------------|---------|
| Nominal Lifespan | 100000H |
| Rated Lifespan | 100000H |
| Turn on-off Times | 40000 |
| Luminous flux maintenance rate | > 70% |

■ Certificate/Standard:

| | |
|--------------------------|-------------------------|
| IP level | IP20 |
| Certificates | TUV-CE/SAA/CE/RoHS/LM79 |
| Energy efficiency rating | A++ |
| Energy consumption | > 70% |

■ Reliability tests

| | Equipment | Standard | Time/times | Sampling QTY | Result |
|-------------------------|-----------------------|------------------|-------------------------------|--------------|--------|
| High temperature | High-low Temp Chamber | IEC60068-2-2 | 24H | 10 | OK |
| Low temperature | High-low Temp Chamber | IEC60068-2-2 | 24H | 10 | OK |
| High-Low Temp. | High-low Temp Chamber | IEC60068-2-38 | 24H | 10 | OK |
| Drop test | Drop test stand | IEC60068-2-32 | 10 times | 6 | OK |
| Vibration | Vibration tester | IEC60068-2-64 | 30min | 6 | OK |
| Impact test | AC power supply/relay | Normal temp/volt | on 30s/off 30s 10000 times | 6 | OK |
| Adhesion test | Knife/Tape | GBT9286-1998 | 10 times | 10 | OK |



■ Detailed parameters

| Main model | SL-DG2-0606XT-G8-S-F | SL-DG3-0909XT-G8-S-F | SL-DG4-1010XT-G8-S-F | SL-DG4-1515XT-G8-S-F | SL-DG5-1616XT-G8-S-F | SL-DG5-1616XT-G8-S-F |
|----------------|-------------------------------------|----------------------|----------------------|----------------------|----------------------|----------------------|
| Power: | 6W | 9W | 10W | 15W | 16W | 20W |
| Luminous flux: | 1200LM | 1800LM | 2000LM | 3000LM | 3200LM | 4000LM |
| CCT: | 3000K/4000K/5000K/5700K/6000K/6500K | | | | | |
| Input Volt: | AC100-240V | | | | | |
| Frequency: | 50/60Hz | | | | | |
| CRI: | ≥80 | | | | | |
| PF: | 0.92 | | | | | |

■ Main components

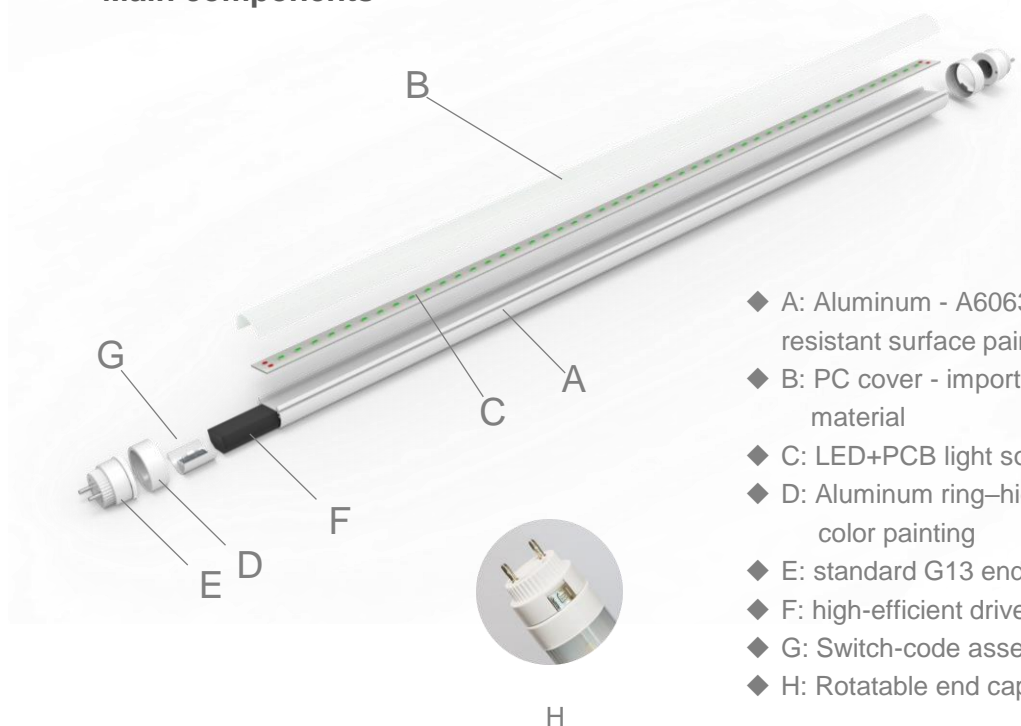

■ Optical parameter diagram

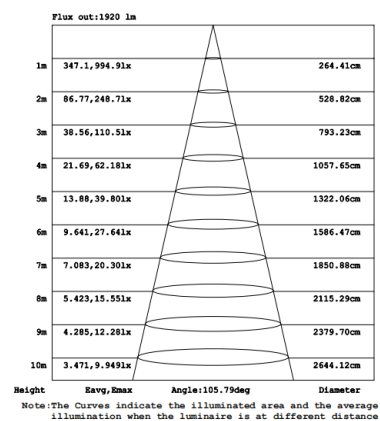
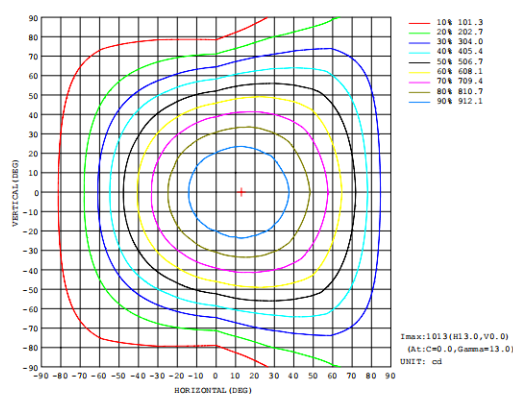
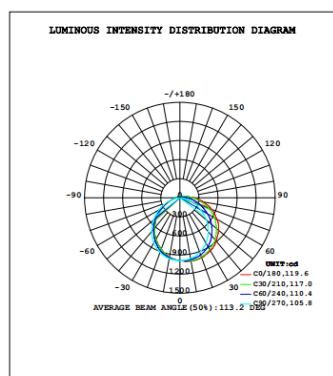

■ Standard power connection:

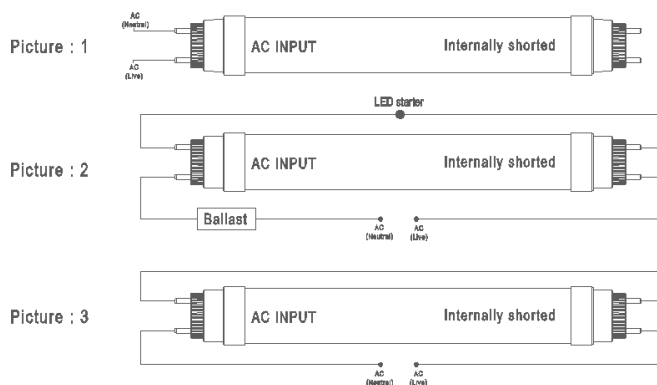

◆ Installation

WARNING: Do not connect mains to "internally shorted" end! follow picture 1.

Magnetic ballast retrofit: remove starter and replace with a LED starter, follow picture 2.

Electronic ballast: remove ballast from the circuit, **WARNING!** Only a trained electrician can do this modification! follow picture 3

— rated input voltage AC100-240V —

■ Installation and precautions:

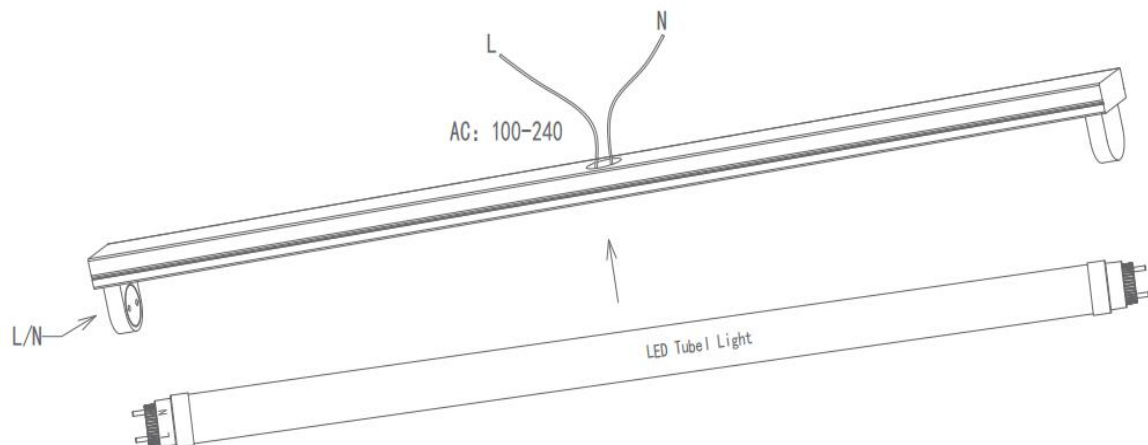

Installation steps:

- ◆ Turn off the power before installation
- ◆ Make sure the working circuit conforms to the schematic diagram of the product or modify the circuit according to the power connection schematic diagram.
- ◆ Confirm the live end of the lamp holder, the other end cannot be connected to live line, and confirm which is the input end of the lamp.
- ◆ When the tube has a label with a clear AC input mark in one end and another end is short-circuit end, then the short-circuit end cannot be connected to the power inlet of the bracket.
- ◆ Install the tube in the bracket correctly and check whether it has been installed properly.
- ◆ Close the power switch to energize after above steps all finished

Precautions:

- ◆ Make sure to disconnect the power supply before installing or removing the lamp
 - ◆ and use the lamp in the rated voltage range.
 - ◆ Indoor use only, do not use this product in high humidity or dusty environment.
 - ◆ Contact the professional maintenance staff to handle if there is any defection.
 - ◆ Do not look at the lamp for long time when the lamp is working,
 - ◆ because the high-brightness light source may cause eye discomfort or damage.
 - ◆ This lamp is a non-dimmable product, please do not use it with a dimmer.
 - ◆ The lamp should not be used near flammable objects
-
- Warning: The lamp can't be covered by heat heat-proof pad or similar material.
 - Warning: To reduce the risk of fire and clicks, do not modify the external structure of the lamp (aluminum groove and end cover) and internal parts by yourself.
 - Warning: In order to reduce the risk of fire and clicks, the mechanics shall understand the electrical system if they need to install the lamp setting.
 - Warning: To prevent damage or abrasion of the wire, please do not expose the wire to the edge of a metal sheet or any other sharp objects.

■ ERP Labels

