

S803-S200 series T8 LED Tube
High efficiency | Wattage switchable

200lm/w



Specification

Factory P/N: SL-S803-S200

Version No.: Ver 02

Date: 2020.08.19

Client approval	Approval	Approval	Confirmation



Applications

- ◆ Indoor illumination at $-20^{\circ} \sim +48^{\circ} \text{ C}$
- ◆ Living area illumination
- ◆ Office area illumination
- ◆ Workshop area illumination
- ◆ Parking lot & hotel area illumination
- ◆ Super market & grocery store illumination

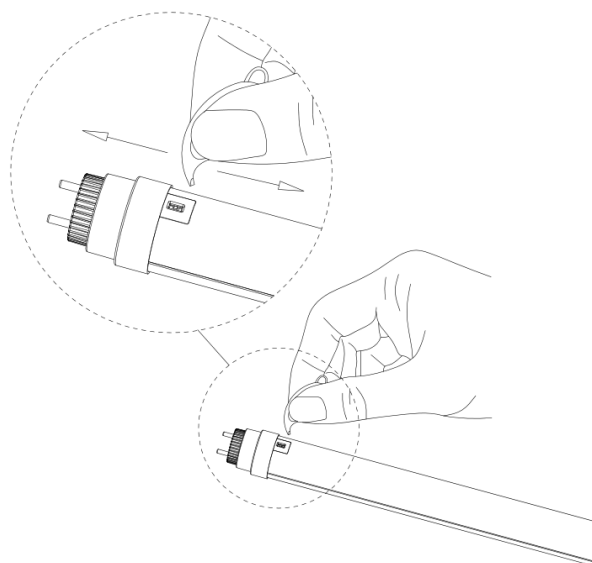

Benefits

- ◆ A6063 aluminum material with excellent heat dissipation, not easy to deform
- ◆ SPD 3KV, effectively prevent the tube from being damaged by on-off switch or instant high voltage
- ◆ Special coating to avoid aluminum exposure
- ◆ Optimal energy conversion, much lower temperature
- ◆ Suitable for lower ambient temperature using

Diagram of code switch for power adjustment

0.6M		6W	0.9M		9W
		9W			12W
1.2M		10W	1.2M		12W
		15W			18W
1.047M		10W	1.5M		16W
		15W			24W

Features

- ◆ Safer and more reliable, leading technology
- ◆ Greener and more energy saving, durable structure
- ◆ Higher efficacy to save much more energy
- ◆ Longer Lifespan for very less heat

■ Model number naming rules:

S803 series Tube

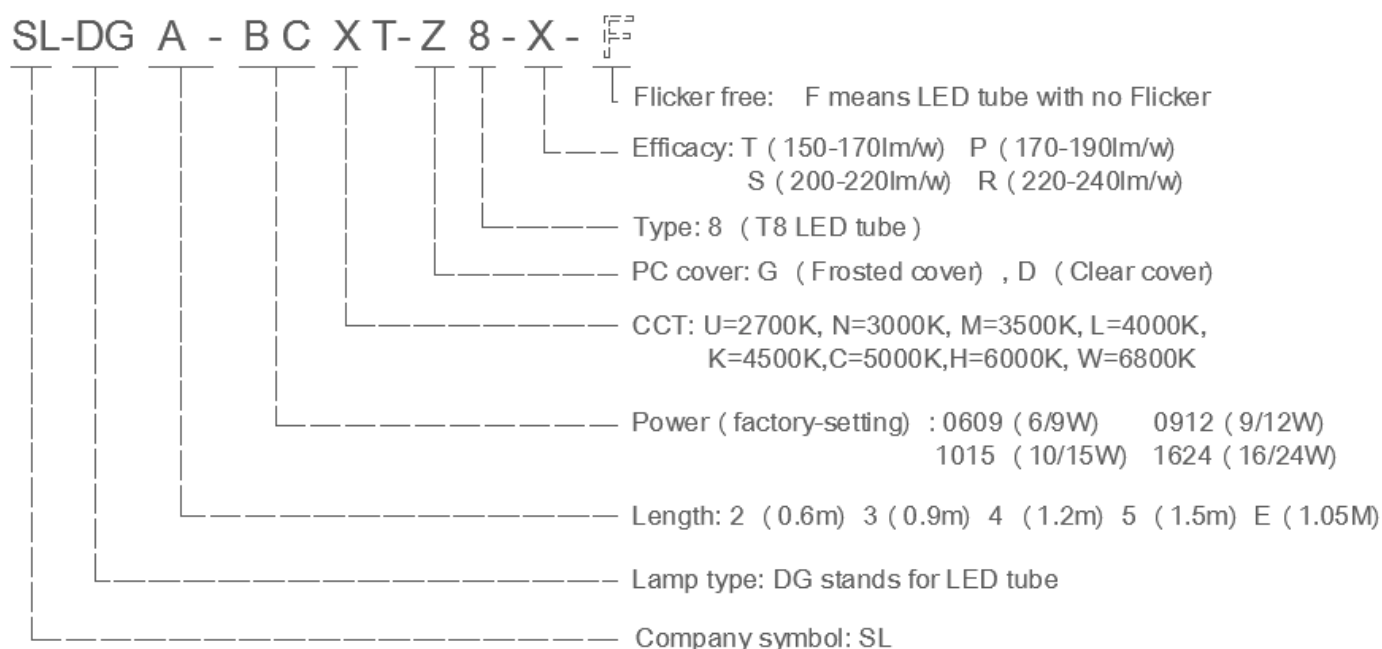

— This series of products are all named according to the above rules —

■ Product Dimension:

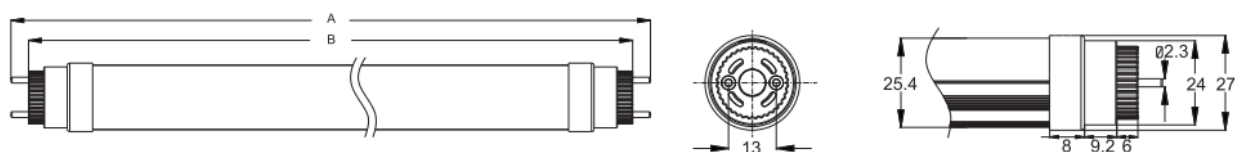

	0.6m	0.9m	1.047m	1.2m	1.5m
A	603mm	907mm	1061mm	1213mm	1513mm
B	588mm	892mm	1047mm	1198mm	1498mm

■ Basic technical parameters

Product Length	0.6m	0.9m	1.2m		1.5m	
Rated Power Switchable	6W	9W	10W	15W	16W	20W
Efficacy	200LM/W					
Rated current	0.5A					
PF	0.92					
CCT	3000K / 4000K / 5000K / 5700K /600K/ 6500K					
CRI	≥80					
Beam angle	Clear cover 120° / Frosted cover 140°					
Start time	< 5S					
Heating time	0.5 hours (heating 60%)					
Dimmable	No					

■ Life Time:

Nominal Lifespan	100000H
Rated Lifespan	100000H
Turn on-off Times	40000
Luminous flux maintenance rate	> 70%

■ Certificate/Standard:

IP level	IP20
Certificates	TUV-CE/SAA/CE/RoHS/LM79
Energy efficiency rating	A++
Energy consumption	> 70%

■ Reliability tests

	Equipment	Standard	Time/times	Sampling QTY	Result
High temperature	High-low Temp Chamber	IEC60068-2-2	24H	10	OK
Low temperature	High-low Temp Chamber	IEC60068-2-2	24H	10	OK
High-Low Temp.	High-low Temp Chamber	IEC60068-2-38	24H	10	OK
Drop test	Drop test stand	IEC60068-2-32	10 times	6	OK
Vibration	Vibration tester	IEC60068-2-64	30min	6	OK
Impact test	AC power supply/relay	Normal temp/volt	on 30s/off 30s 10000 times	6	OK
Adhesion test	Knife/Tape	GBT9286-1998	10 times	10	OK



■ Detailed parameters

Main model	SL-DG2-0606XT-G8-S-F	SL-DG3-0909XT-G8-S-F	SL-DG4-1010XT-G8-S-F	SL-DG4-1515XT-G8-S-F	SL-DG5-1616XT-G8-S-F	SL-DG5-1616XT-G8-S-F
Power:	6W	9W	10W	15W	16W	20W
Luminous flux:	1200LM	1800LM	2000LM	3000LM	3200LM	4000LM
CCT:	3000K/4000K/5000K/5700K/6000K/6500K					
Input Volt:	AC100-240V					
Frequency:	50/60Hz					
CRI:	≥80					
PF:	0.92					

■ Main components

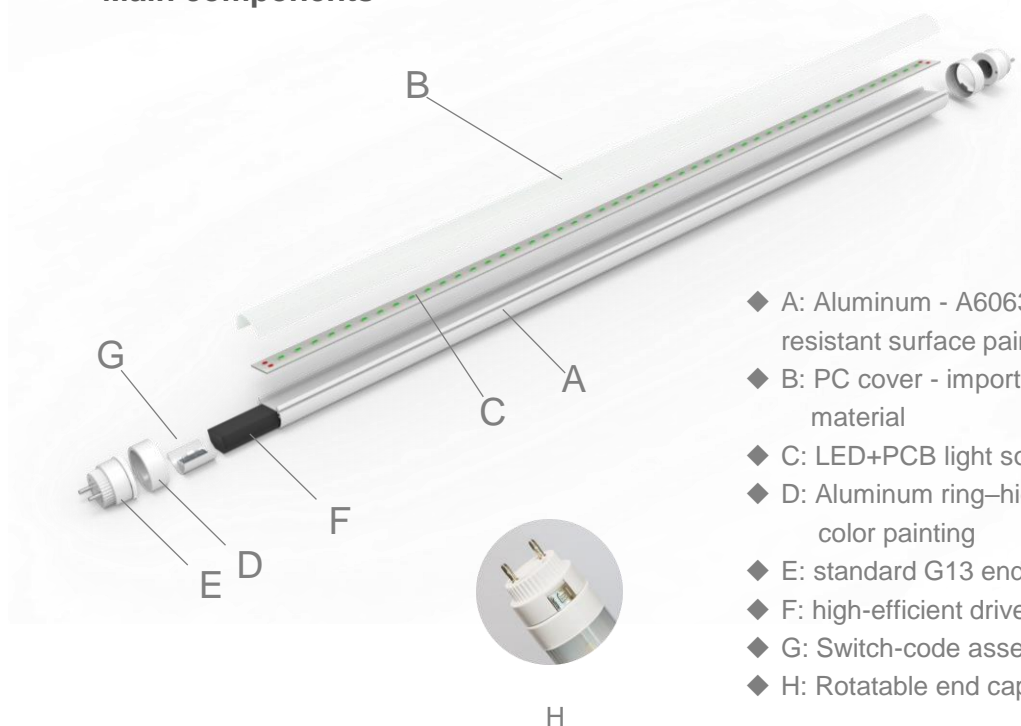

■ Optical parameter diagram

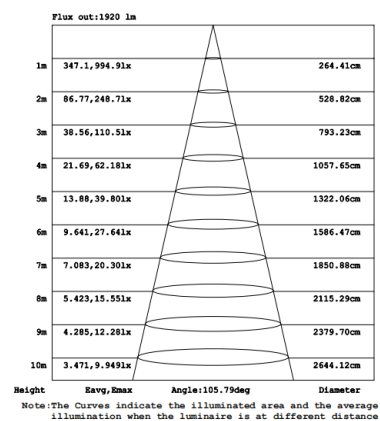
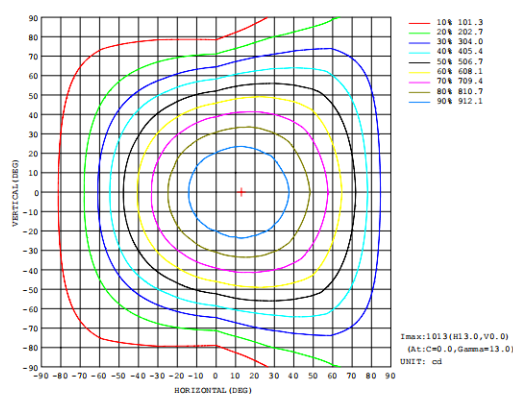
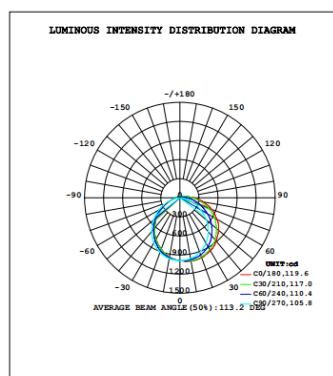

■ Standard power connection:

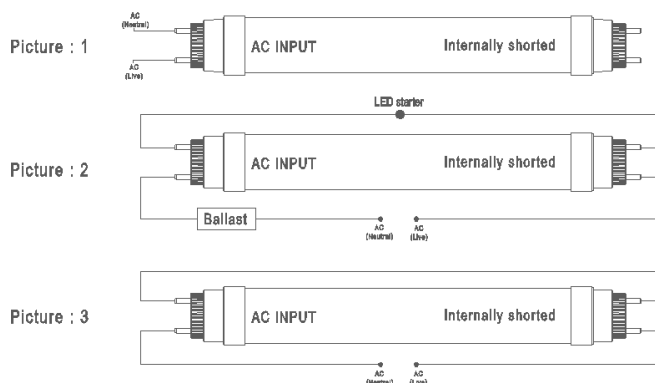

◆ Installation

WARNING: Do not connect mains to "internally shorted" end! follow picture 1.

Magnetic ballast retrofit: remove starter and replace with a LED starter, follow picture 2.

Electronic ballast: remove ballast from the circuit, **WARNING!** Only a trained electrician can do this modification! follow picture 3

— rated input voltage AC100-240V —

■ Installation and precautions:

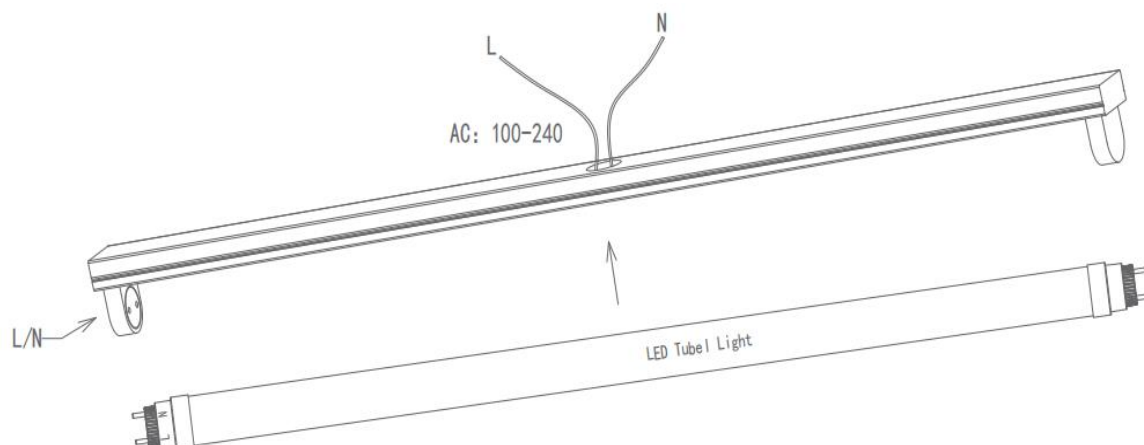

Installation steps:

- ◆ Turn off the power before installation
- ◆ Make sure the working circuit conforms to the schematic diagram of the product or modify the circuit according to the power connection schematic diagram.
- ◆ Confirm the live end of the lamp holder, the other end cannot be connected to live line, and confirm which is the input end of the lamp.
- ◆ When the tube has a label with a clear AC input mark in one end and another end is short-circuit end, then the short-circuit end cannot be connected to the power inlet of the bracket.
- ◆ Install the tube in the bracket correctly and check whether it has been installed properly.
- ◆ Close the power switch to energize after above steps all finished

Precautions:

- ◆ Make sure to disconnect the power supply before installing or removing the lamp
- ◆ and use the lamp in the rated voltage range.
- ◆ Indoor use only, do not use this product in high humidity or dusty environment.
- ◆ Contact the professional maintenance staff to handle if there is any defection.
- ◆ Do not look at the lamp for long time when the lamp is working,
- ◆ because the high-brightness light source may cause eye discomfort or damage.
- ◆ This lamp is a non-dimmable product, please do not use it with a dimmer.
- ◆ The lamp should not be used near flammable objects

- Warning: The lamp can't be covered by heat heat-proof pad or similar material.
- Warning: To reduce the risk of fire and clicks, do not modify the external structure of the lamp (aluminum groove and end cover) and internal parts by yourself.
- Warning: In order to reduce the risk of fire and clicks, the mechanics shall understand the electrical system if they need to install the lamp setting.
- Warning: To prevent damage or abrasion of the wire, please do not expose the wire to the edge of a metal sheet or any other sharp objects.

■ ERP Labels

